

## Safety Machine safety services

### Safety at Leuze

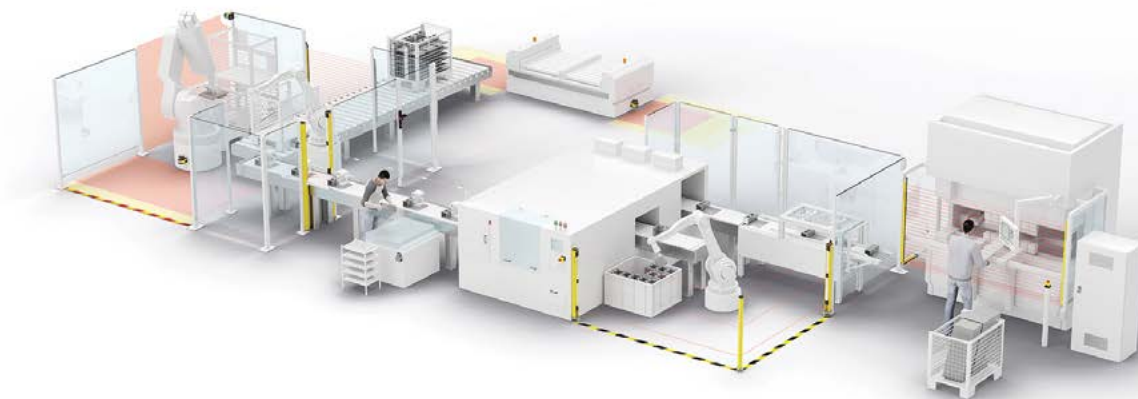

	Services	Description	Details
	Machine Safety Review	Review of the machine safety system and guarding.	Report in form of a checklist showing compliance or non-compliance to current Australian/International standards.
	Team Based Risk Assessment	Risk assessment with operation/maintenance team to identify all hazards, estimate risk and identify suitable risk reduction strategy.	Comprehensive report - risk assessment outcome, current state, recommended risk reduction strategy and details of safety function by safety related part of the control system.
	Safety Requirement Specification	Detailed specification of each safety function to be executed by the safety related part of the control system.	Specifications to include detailed functionality, operational interface requirements and integration to the machine control system.
	Safety Design	Concept design.	Concept design of the safety related part of the control system to meet the safety requirement specification and verification of design using SISTEMA tool.
	Safety Verification	Verification of the design.	Verification of the design by review and documented report detailing the performance level (PL) or safety integrity level (SIL) achieved by the safety related part of the control system.
	Safety Circuit Analysis	Analysis and documented report of the safety system design.	A third party analysis of the safety circuit designed. A documented report details any non compliance with remediation strategy along with the Performance Level (PL)/Safety Integrity Level (SIL) achieved by the safety circuit.
	Safety System Validation	Review of the safety system installation and functionality.	The validation involves review, analysis and testing of the safety system to ensure that the safety system is installed as per safety related specification.
	Stop Time Measurement	Measurements performed by experts with calibrated measurement devices.	Well documented test results in accordance with DIN ISO 900:2015 and optional graphic analysis of the machine stop time for installation of safety devices and early detection of wear and tear in brake components with periodic inspections.
	Safety Training	Training on the safety processes and safety standards for managing machinery safety.	- Customised training on function safety standards, safety applications and safety products. Training available - at customer sites or at Leuze office.

## Safety Solutions Applications at a glance

### Safety at Leuze

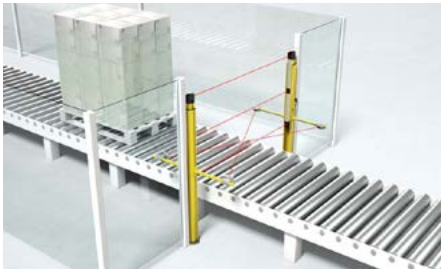

Access guarding with muting

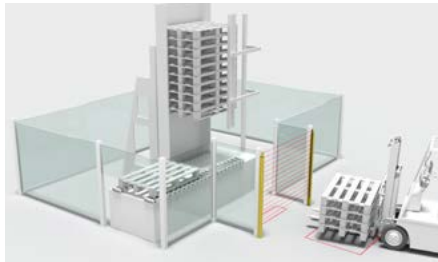

Access guarding at pallet magazine

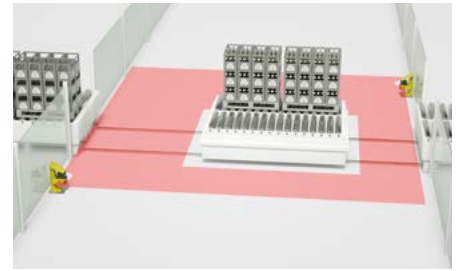

Safeguarding of traffic area

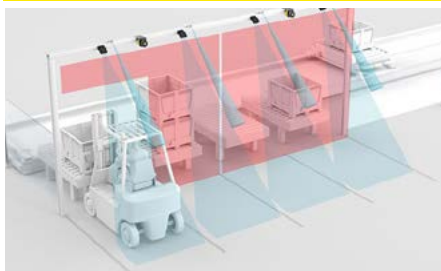

Multi-station access guarding



Access guarding at material output station



Safe position detection



Access guarding of the aisle

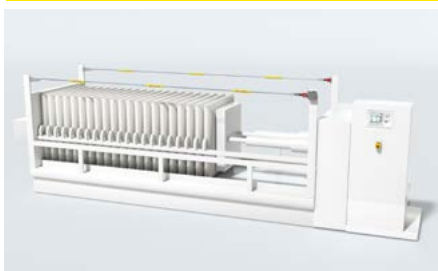

Triggering of an emergency stop



Securing of safety guards



Point of operation guarding



Monitoring of doors and flaps



Integration of safety sensors

Leuze electronic Pty Ltd  
Phone: 1300 538 933  
Email: [sales.au@leuze.com](mailto:sales.au@leuze.com)  
[www.leuze.com.au](http://www.leuze.com.au)  
[www.leuze-australia.com.au](http://www.leuze-australia.com.au)

**The Sensor People**

If you'd like us to get in contact with you  
click on the link:  
[Contact form](#)